

# Waubesa Wetlands

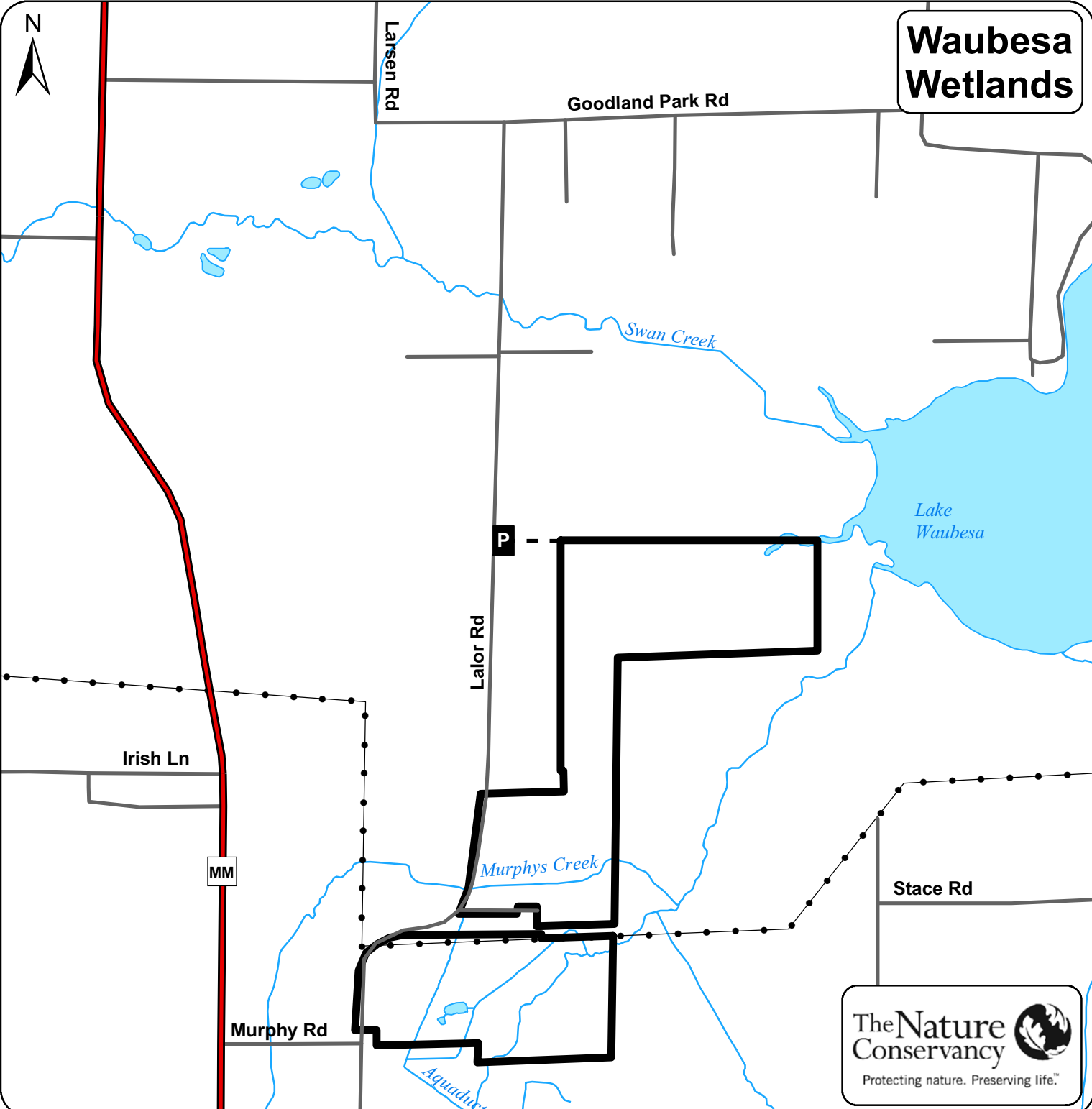

- Preserve boundary
- Parking
- Access lane
- Transmission line
- River / Stream
- Lake
- Highway
- Local road

Directions from Madison: Travel south on US Hwy 14 approximately 0.5 miles to the County Highway MM (McCoy Rd) exit. Take the County Highway MM exit. When you get to the bottom of the exit, take a left onto MM and go under Hwy 14 to the stop sign. Take a right at the stop sign onto McCoy Rd. Travel 1.25 miles to Goodland Park Rd. Turn left (east) onto Goodland Park Rd; travel 0.5 mile to Larsen Rd (T intersection). Turn right (south) onto Larsen; travel 0.5 miles to Lolor Rd. Turn right onto Lolor Rd; travel 0.75 miles to preserve entrance on left (east) side of road. Park in the small parking area just beyond entrance or along the side of the road. To reach the preserve, walk east along the access lane for 0.25 miles.

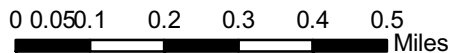

July 8, 2009

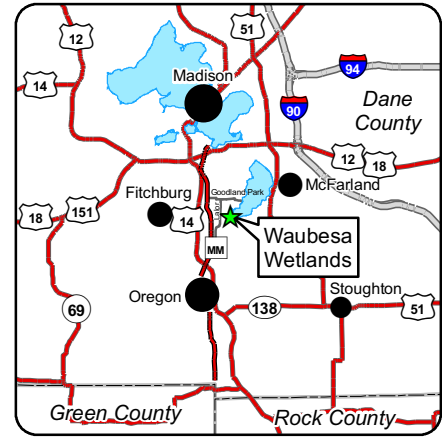

# Waubesa Wetlands

---

In Madison's Backyard, a "living museum" of native plant and animal communities

## Why You Should Visit

This preserve is part of one of Wisconsin's most studied and valued water habitats.

The marshy terrain provides good habitat for many species of waterfowl and other migrating birds. The wetlands are fed by numerous small springs that provide a continuous flow of clear, cool water. (One of the most impressive of these is Bogholt Deep Spring, which originates in an underground cave.)

## Hours

Open year round, dawn to dusk

## How to Get the Most from Your Visit

No established hiking trails exist; the best way to view the preserve is from a canoe. You can put in from the boat launch area at Goodland County Park. The park does not offer canoe rentals.

## What to See: Plants

- Southern sedge meadow (a state-threatened community)
- In the meadows: bluejoint grass and tussock sedge amid a scattering of sawgrass sedge, cattails and bur-reed
- A fen community of brome grass, aster, goldenrod and sage willow

## What to See: Animals

Though difficult to traverse for humans, the marshy terrain is an important nesting area for many species of waterfowl and other migrating birds, including the following: American bitterns, American coots, blue-gray gnatcatchers, Canada geese, common yellowthroats, great blue herons, and sandhill cranes.

The waters of the preserve also provide a major fish spawning area, especially for northern pike (early to mid-spring).

## Why the Conservancy Selected This Site

The Waubesa Wetlands Preserve contains high-quality, spring-fed wetlands. Close to Madison, it is used extensively for research and education.

## What the Conservancy Has Done/Is Doing Here

Since 1974, the Conservancy has protected 231 acres.

To protect the integrity of these wetlands, the Conservancy continues to work closely in a conservation partnership with the Wisconsin Department of Natural Resources Natural Areas Program. Volunteers are helping to restore the wetlands and surrounding woodlands by removing invasive species and conducting controlled burns.